

The Path less traveled.

Everything in Illustrator is a path. This can be a line made by the traditional pen tool (like what we use in Photoshop) or a brush or pencil stroke. Even the shapes are paths that can be edited, manipulated, and altered. A path is made up of **segments** and **anchor points**. When an anchor point is selected you will notice a set of handle bars appear that can be dragged and edited to change the shape of the path.

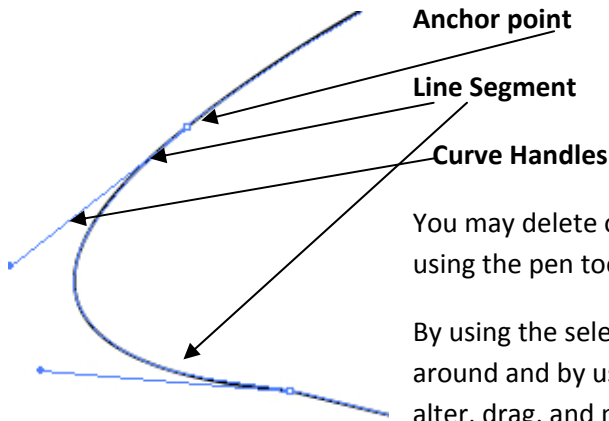

You may delete or add anchor points to change the shape of an object by using the pen tool.

By using the selection arrow (the black arrow) you can move the path around and by using the direct selection tool (the white arrow) you may alter, drag, and move the anchor points.

Create a fish in Illustrator. Drag out an ellipse to begin and then alter the anchor points. Add fins, eyes, etc. to make your cartoon. To move an object/shape around either put them on separate layers and change the layer order or use the Object>Arrange> Move back menu.

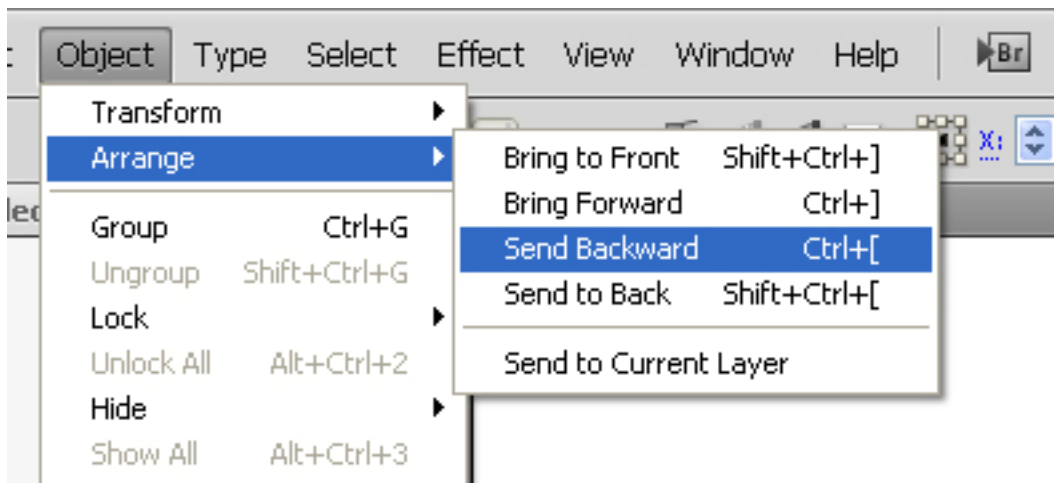

Once you have finished the fish make at least two additional cartoon characters using paths and shapes. Include a background for these characters.